

**HVB Tower Munich  
Munich, Germany**

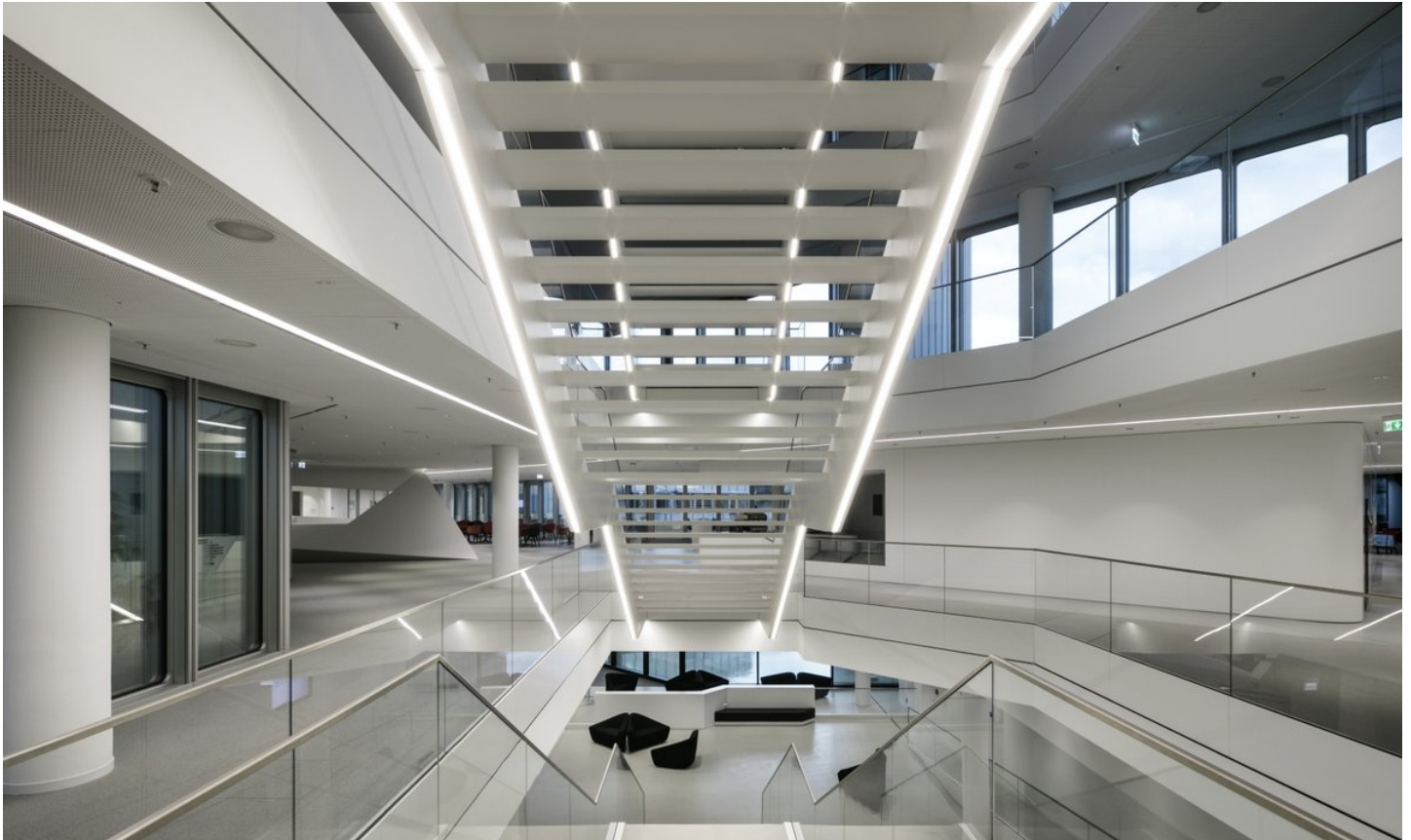

---

project	HVB Tower Munich
client	Bauer Elektroanlagen Süd, Buchbach
architect	Henn Architekten, Munich
lighting designer	Schmidt König Lichtplaner, Munich
photographer	Hans-Georg Esch

---

Modifications are possible due to the constant development and improvement of LED technology.

© Selux Corporation, Subject to technical modification 6.2017

Selux Corporation, 5 Lumen Lane, P.O. Box 1060, Highland, NY 12528

## HVB Tower Munich Munich, Germany

With its futuristic façade, the 114 meter high HVB Tower at the Arabellapark has formed part of the Munich skyline since 1981. This headquarters of the HypoVereinsbank, which was assigned the status of a listed building in 2006, has now been extensively modernized according to plans by Henn architects. Besides energy aspects, the office complex itself has also been spruced up so that this sustainable green building with its flexible office landscapes is now fully geared for the smart work age.

When it came to upgrading most of the lighting technology on the 140,000 square metre gross floor space, Selux turned to M36 luminaire to realize the light planners' LED lighting concept. An asymmetrical Light Modulation Optic (LMO) by Selux has been installed in the 36 mm narrow profile to enable particularly asymmetrical light distribution – despite the low distance between wall and luminaire. The linear light fixtures cast a pleasant uniform light throughout the corridors, with the light concept allowing both for LED lighting that is daylight-dependent but at the same time individually controllable. M36 light lines have been inserted into the underside of the stair stringers too, providing an optimal setting for the steps below, the indirect light also ensuring safe footing. The light line is continued in the sanitary areas too – above the mirrors, integrated M36 luminaires ensure homogeneous illumination. And the prestigious nature of the 24<sup>th</sup> floor – the executive floor of the bank – is emphasized by means of light too, with special LMO Wallwasher optics ensuring maximum lighting uniformity.

## HVB Tower Munich Munich, Germany

Modifications are possible due to the constant development and improvement of LED technology.

© Selux Corporation, Subject to technical modification 6.2017

Selux Corporation, 5 Lumen Lane, P.O. Box 1060, Highland, NY 12528

Modifications are possible due to the constant development and improvement of LED technology.

© Selux Corporation, Subject to technical modification 6.2017

Selux Corporation, 5 Lumen Lane, P.O. Box 1060, Highland, NY 12528

## HVB Tower Munich Munich, Germany

M36 - 1-1/2" wide linear lighting with  
wide optical range



M36 LED is constructed from 1-7/16" (37mm) wide extruded low copper aluminum housing and die cast endcaps · Exact cut lengths, lit corners, and project-specific Configurations may be specified · Impact-resistant lenses offer controlled lighting, protect against dust, and ensure high luminaire efficiency · Modular design allows for easy access to optical chamber · Available with LED Optimized White acrylic lens (Flush, 37mm Drop, or 6mm Light Up), Clear lens with Microprism inlay, Symmetric LMO lens, 5° Asymmetric LMO lens, 20° Asymmetric LMO lens, Batwing LMO, and Comfort Louver with a variety of finishes. Selux offers multiple LED options including LEDs in static 2700K, 3000K, 3500K, or 4000K CCTs at 80+ and 90+ CRI, My White tunable white in 2700K - 6500K at 90+ CRI, BIOS SkyBlue® Technology at 83+ CRI, and RGBW. All LED options are within a 3-step MacAdam ellipse. Custom lumen outputs are also available upon request. M36 LED Regressed lighting offers the advantages a hidden light source and energy efficiency · Regressed lighting attractively fits into any kind of ceiling and can be applied for commercial, retail, and various other applications to transform general lighting into something special.

Modifications are possible due to the constant development and improvement of LED technology.

© Selux Corporation, Subject to technical modification 6.2017

Selux Corporation, 5 Lumen Lane, P.O. Box 1060, Highland, NY 12528

## M36 Pendant



Construction	Extruded 6063-T6 aluminum construction · Easy access to optical chamber
Optic	LED Optimized White lens · Clear lens with Microprism inlay · LMO Symmetric · LMO Asymmetric 20° Wall Washer · A5 LMO Asymmetric 5° Wall Grazer · LMO Batwing · LMO Indirect Wide Batwing · Drop Lens · Light Up Lens · Comfort Louver in a variety of finishes
Light Source	LEDs in static 2700K, 3000K, 3500K, or 4000K at 80+ or 90+ CRI · My White Tunable White 2700K - 6500K at 90+ CRI · RGBW upon request · Luminaire efficacy up to 140lm/W at 80+ CRI
Luminous flux	Up to 1296lm per foot (Direct or Indirect) and 2592lm per foot (Direct/Indirect) at 80+ CRI
Light Distribution	Direct · Indirect · Direct/Indirect
Mounting	Cable · Rigid Stem · Swivel Stem
Dimensions	1-7/16" wide (37mm) x 2-13/16" high (72mm) for Direct or Indirect, 4-1/8" high (104mm) for Direct/Indirect · Available in approximately 1-1/2" increments · Project-specific lengths are available upon request
Finish	Tiger Drylac certified polyester powder coat finish
Options	Damp location · In-line Fuse · Separate Switching · Emergency Circuit wiring · Corners (L, T, and X) · Configuration options · Multiple dimming options and integral sensors for energy savings
Certificates	NRTL Damp Location · 5 Year LED Warranty · ARRA Compliant · ADA Compliant · RoHS Compliant · Union Made - IBEW Local 363 · ASTM and PCI for finish · NGL 2013 · PIA 2013 · nLight enabled · enlightened enabled
[en:]	Interior
[en:]	M36 - Selux + BIOS

## M36 Surface



Construction	Extruded 6063-T6 aluminum construction · Easy access to optical chamber
Optic	LED Optimized White lens · Clear lens with Microprism inlay · LMO Symmetric · LMO Asymmetric 20° Wall Washer · A5 LMO Asymmetric 5° Wall Grazer · LMO Batwing · Drop Lens · Light Up Lens · Comfort Louver in a variety of finishes
Light Source	LEDs in static 2700K, 3000K, 3500K, or 4000K at 80+ or 90+ CRI · My White Tunable White 2700K - 6500K at 90+ CRI · RGBW upon request · Luminaire efficacy up to 140lm/W at 80+ CRI
Luminous flux	Up to 1296lm per foot at 80+ CRI
Light Distribution	Direct
Mounting	Surface Mount

Modifications are possible due to the constant development and improvement of LED technology.

© Selux Corporation, Subject to technical modification 6.2017

Selux Corporation, 5 Lumen Lane, P.O. Box 1060, Highland, NY 12528

## M36 Recessed



Construction	Extruded 6063-T6 aluminum construction · Easy access to optical chamber
Optic	LED Optimized White lens · Clear lens with Microprism inlay · LMO Symmetric · LMO Asymmetric 20° Wall Washer · A5 LMO Asymmetric 5° Wall Grazer · LMO Batwing · Drop Lens · Light Up Lens · Comfort Louver in a variety of finishes
Light Source	LEDs in static 2700K, 3000K, 3500K, or 4000K at 80+ or 90+ CRI · My White Tunable White 2700K - 6500K at 90+ CRI · RGBW upon request · Luminaire efficacy up to 140lm/W at 80+ CRI
Luminous flux	Up to 1296lm per foot at 80+ CRI
Light Distribution	Direct
Mounting	Before and after drywall · T-bar · Slot Grid · Decoustic ceiling · Rotating Crossbar · Threaded Stud
Dimensions	1-7/16" wide (37mm), not including any flanges x 2-13/16" high (72mm) · Available in approximately 1-1/2" increments · Project-specific lengths are available upon request
Finish	Tiger Drylac certified polyester powder coat finish
Options	Damp location · In-line Fuse · Separate Switching · Emergency Circuit wiring · Corners (L, T, and X) · Chicago Plenum · Configuration options · Multiple dimming options and integral sensors for energy savings
Certificates	NRTL Damp Location · 5 Year LED Warranty · ARRA Compliant · RoHS Compliant · Union Made - IBEW Local 363 · ASTM and PCI for finish · NGL 2013 · PIA 2013 · nLight enabled · enlightened enabled
[en:]	Interior
[en:]	M36 - Selux + BIOS

## M36 Regressed



Construction	Extruded 6063-T6 aluminum construction · Easy access to optical chamber
Optic	LED Optimized White lens · Clear lens with Microprism inlay · LMO Symmetric · LMO Asymmetric 20° Wall Washer · A5 LMO Asymmetric 5° Wall Grazer · LMO Batwing
Light Source	LEDs in static 2700K, 3000K, 3500K, or 4000K at 80+ or 90+ CRI · My White Tunable White 2700K - 6500K at 90+ CRI · RGBW upon request · Luminaire efficacy up to 138lm/W at 80+ CRI
Luminous flux	Up to 1258lm per foot at 80+ CRI
Light Distribution	Direct
Mounting	Before drywall · T-bar · Rotating Crossbar · Threaded Stud
Dimensions	1-7/16" wide (37mm), not including flanges x 3-13/16" high (97mm) · Available in approximately 1-1/2"

Modifications are possible due to the constant development and improvement of LED technology.

© Selux Corporation, Subject to technical modification 6.2017

Selux Corporation, 5 Lumen Lane, P.O. Box 1060, Highland, NY 12528

