

Olivio LED

Application Guide



selux

Product Specifications

Light Engine:	Recessed COB, RGBW (Grande only), Gobo Projector (Grande only)
Output:	Up to 5,100lm; up to 98lm/W
CCT:	3000K, 4000K; 3 Step-Binning
Distributions:	9° Narrow Spot, 44° Medium Flood, 78° Flood, Asymmetric (Static White) 13° Narrow Spot, 50° Medium Flood, 80° Flood (RGBW) 19° Narrow Spot, 25° Medium Spot, 30° Wide Spot (Gobo Projector)
Lens Options:	Horizontal Spread Lens, Vertical Spread Lens, Micro Honeycomb Louver, Color Filter
Fixture Options:	Dimming, Hi-Lo Switching, GFCI, Dark Sky 0° Tilt, Solar (Medio only), Integrated Camera (Grande only), Integrated Speaker (Grande only)
Mounting:	Universal, Sistema, Sistema 2, Candelabra, Floracion, Bollard, Wall



The Old Port of Marseille, Marseille, France
Photo courtesy of Xavier Boymond

A Family of Options

Olivio is an impressive, highly efficient lighting concept for urban living environments. The versatility of this product family enables individualized design solutions to create functional and atmospheric lighting.



Universal and Wall Mounting



Bollard

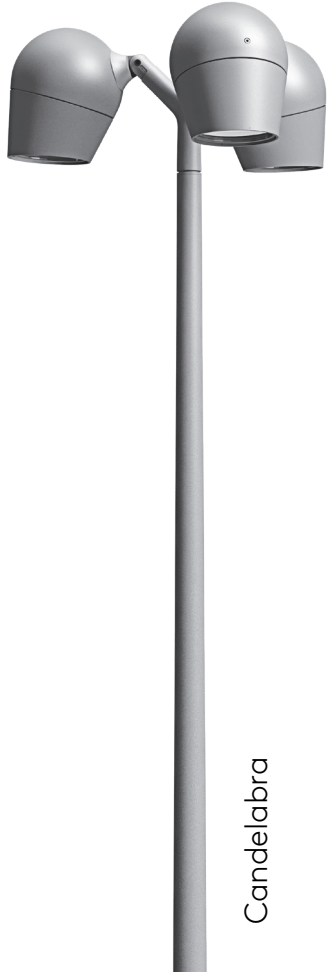

Candelabra



Floracion



Sistema



Sistema 2

Three Luminaire Sizes

Olivio is available in three luminaire sizes- Piccolo, Medio, and Grande. Olivio is offered as a Bollard, or with Universal, Candelabra, Sistema, Sistema 2, and Floracion mountings - ensuring versatility with a cohesive look. Also available as a Solar solution, Olivio Medio is further expanded for usage in remote locations.

Piccolo

5-⁷/₁₆"
(150mm)



Medio

8-¹/₁₆"
(220mm)



Grande

10-³/₁₆"
(275mm)



4-³/₁₆"
(106mm)



6-⁷/₁₆"
(164mm)



8-¹/₁₆"
(205mm)

Grand Prairie City Hall, Grand Prairie, TX
Photo courtesy of Wade Griffith Photography, LLC



Gleisdreieck, Berlin, Germany
Photo courtesy of Claus Boeckh



MassPort Transportation, Boston, MA
Photo courtesy of David Pires Photography



Olivio LED Universal



Surface/Wall Mount

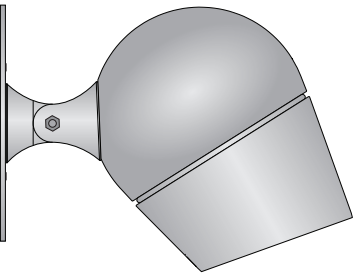

Grande

18-³/₁₆"
(465mm)

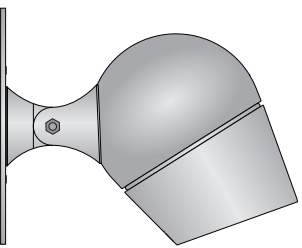

Medio

15-¹/₂"
(394mm)

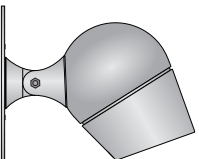

Piccolo

10-³/₁₆"
(255mm)

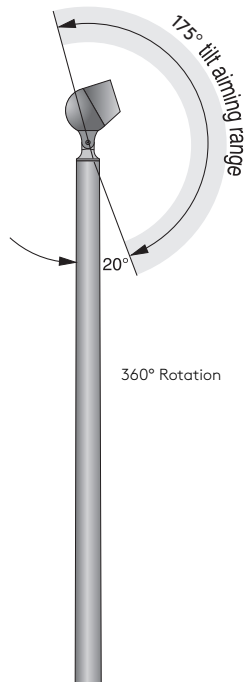

Single Pole Top

Product Specifications

- Series:** Piccolo, Medio, Grande
- Light Engine:** Recessed COB, RGBW (Grande only), Gobo Projector (Grande only)
- Output:** 600 - 5,100lm Nominal
- CCT:** 3000K, 4000K; 3 Step-Binning
- Distributions:** 9° Narrow Spot, 44° Medium Flood, 78° Flood, Asymmetric (White)
13° Narrow Spot, 50° Medium Flood, 80° Flood (RGBW)
19° Narrow Spot, 25° Medium Spot, 30° Wide Spot (Gobo)
- Lens Options:** Horizontal Spread Lens, Vertical Spread Lens, Micro Honeycomb Louver, Color Filter
- Options:** Dimming, Hi-Lo Switching, Dark Sky 0° Tilt
- Mounting:** Universal (surface/wall mount), Single Pole Top

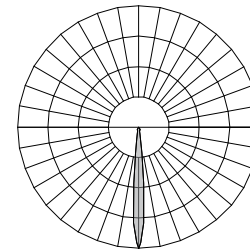

9° Spot
76,650cd

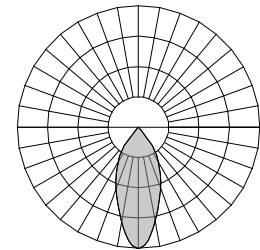

44° Medium Flood
8,235cd

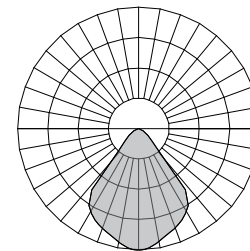

78° Flood
3,448cd

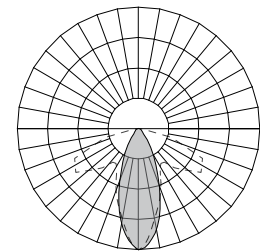

Asymmetric
3,738cd

*Performances of Olivio Grande at 3000K

Refer to fixture specification sheet for detailed information on mounting configurations.

Olivio LED Bollard

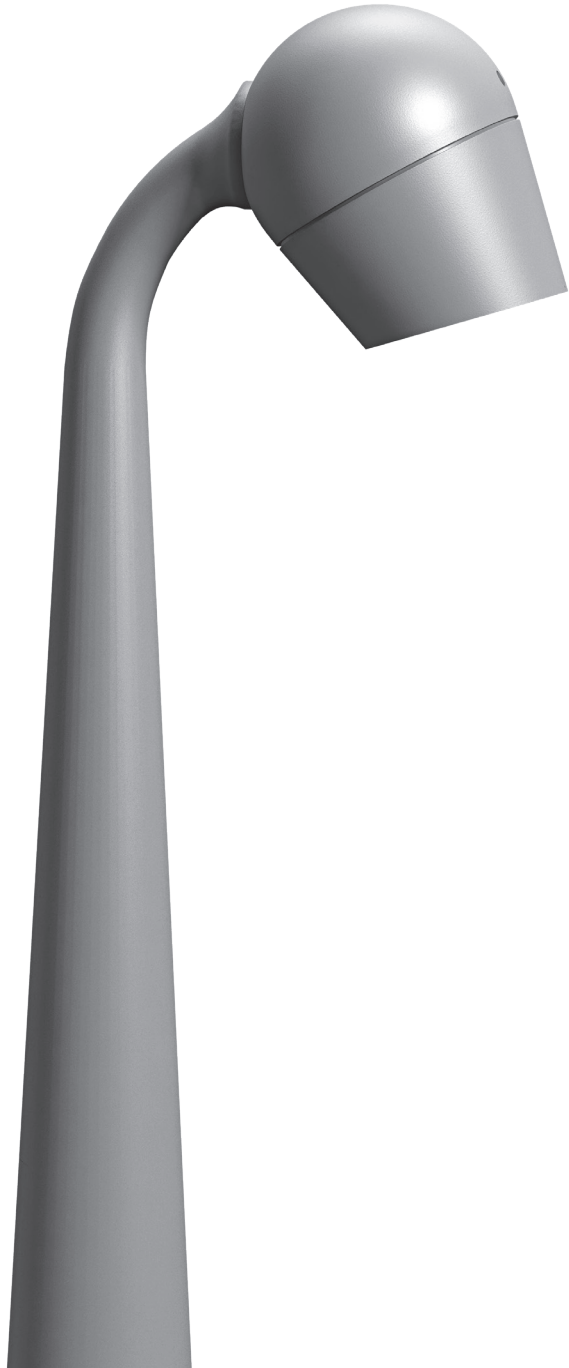

Product Specifications

Series:	Piccolo, Medio
Light Engine:	Recessed COB; 80+ CRI (White)
Output:	600 - 4,100lm Nominal
CCT:	3000K, 4000K; 3 Step-Binning
Distribution:	Asymmetric
Options:	Dimming, Surge Suppression

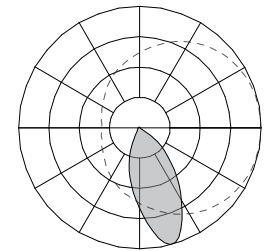

Asymmetric
3,758cd

*Performances of Olivio Medio at 3000K

Medio

14-³/₈"
(365mm)

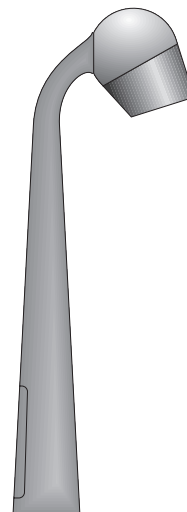

49-³/₈"
(1250mm)

Piccolo

10-³/₈"
(255mm)

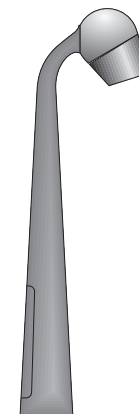

39-³/₈"
(1000mm)



Apartment Area Chaz Yorkville, Toronto, Canada
Photo courtesy of Light Monkey Photography, Toronto

Environmental Nature Center Preschool, Newport Beach, CA
Photo courtesy of Roger Gregston, PLP



Lido Auebad, Kassel, Germany



Olivio LED Candelabra

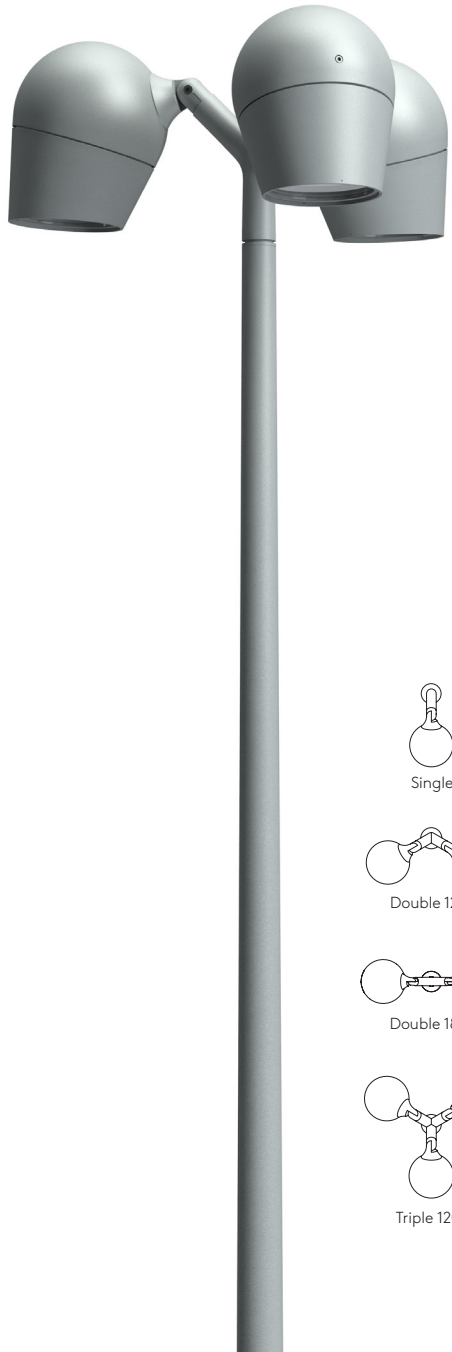

Product Specifications

- Series:** Medio, Grande
- Light Engine:** Recessed COB, RGBW (Grande only), Gobo Projector (Grande only)
- Output:** 1,250lm - 5,000lm nominal
- CCT:** 3000K, 4000K; 3 Step-Binning
- Distributions:** 9° Narrow Spot, 44° Medium Flood, 78° Flood, Asymmetric (White)
13° Narrow Spot, 50° Medium Flood, 80° Flood (RGBW)
19° Narrow Spot, 25° Medium Spot, 30° Wide Spot (Gobo)
- Lens Options:** Horizontal Spread Lens, Vertical Spread Lens, Micro Honeycomb
Louver, Color Filter
- Options:** Dimming, Hi-Lo Switching, Dark Sky 0° Tilt
- Mounting:** Single, Double 120°, Double 180°, Triple 120°

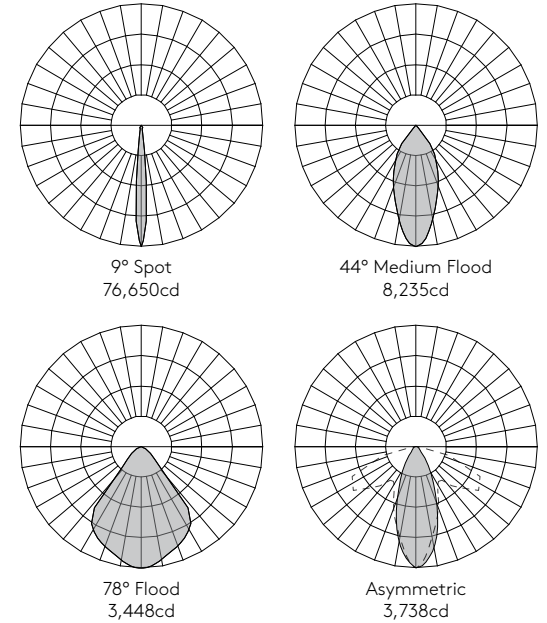

*Performances of Olivio Grande at 3000K

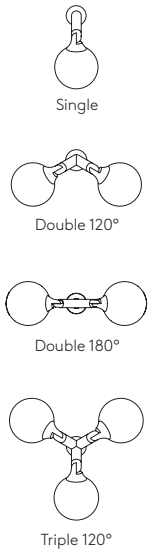

Grande

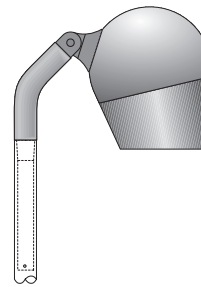

12-¹³/₁₆"
(325mm)

Tenon
1-¹/₂" (42mm)

Medio

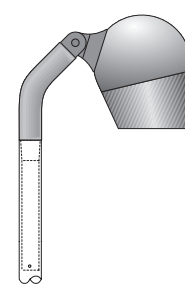

10-¹/₄"
(260mm)

Tenon
1-¹/₂" (42mm)

Refer to fixture specification sheet for detailed information on mounting configurations.

0° to 175° Tilt, 360° Rotation



Neuer Markt, Alexanderplatz, Berlin, Germany
Photo courtesy of Eckhard Joite



East Bund Waterfront, Shanghai, China
Photo courtesy of Zilu Wang

Olivio Medio and Grande Floracion



Product Specifications

- Series:** Medio, Grande
- Light Engine:** Recessed COB, RGBW (Grande only), Gobo Projector (Grande only)
- Output:** 1,250lm - 5,000lm nominal
- CCT:** 3000K, 4000K; 3 Step-Binning
- Distributions:** 9° Narrow Spot, 44° Medium Flood, 78° Flood, Asymmetric (White)
13° Narrow Spot, 50° Medium Flood, 80° Flood (RGBW)
19° Narrow Spot, 25° Medium Spot, 30° Wide Spot (Gobo)
- Lens Options:** Horizontal Spread Lens, Vertical Spread Lens, Micro Honeycomb
Louver, Color Filter
- Options:** Dimming, Hi-Lo Switching, Dark Sky 0° Tilt
- Mounting:** Floracion

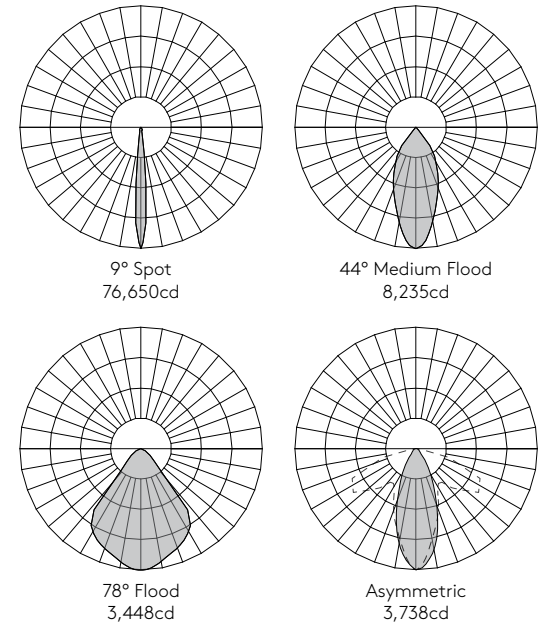

*Performances of Olivio Grande at 3000K

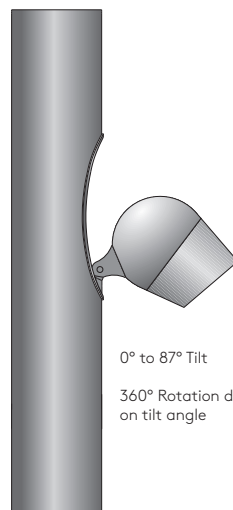

0° to 87° Tilt
360° Rotation dependent
on tilt angle

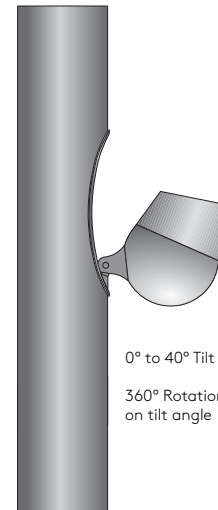

0° to 40° Tilt
360° Rotation dependent
on tilt angle

Refer to fixture specification sheet
for detailed information on mounting
configurations.

Olivio Grande shown as reference.

Olivio Floracion allows the pole and the luminaire to become one.

The Olivio Floracion provides an aesthetic that allows the luminaire to be embraced by the column. The elegant design will inspire without being overly obtrusive.

Consult the factory for various color combinations for luminaire head, column, and Floracion cast insert, providing additional design-enhancing options.



Integrated Optical Design

Every optical lens and filter has been designed to allow you to get the most out of the Olivio family. Create a unique lighting experience with the Micro Honey Comb Louver, Horizontal Spread Lens, Vertical Spread Lens, or Color Filters for monochromatic COB Olivio luminaires.

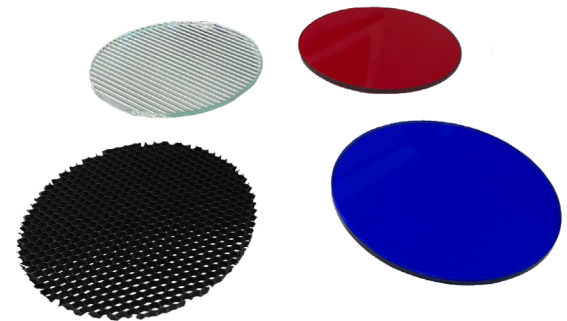



Gleisdreieck, Berlin, Germany
Photo courtesy of Claus Boeckh



City Port, Großbräschen, Germany
Photo courtesy of Claus Boeckh



Porsche Museum, Stuttgart
Photo courtesy of Brigida González

City Port, Großbräschen, Germany
Photo courtesy of Claus Boeckh

Olivio LED Sistema



Product Specifications

- Series:** Medio, Grande
- Light Engine:** Recessed COB, RGBW (Grande only), Gobo Projector (Grande only)
- Output:** 1,250lm - 5,000lm nominal
- CCT:** 3000K, 4000K; 3 Step-Binning
- Distributions:** 9° Narrow Spot, 44° Medium Flood, 78° Flood, Asymmetric (White)
13° Narrow Spot, 50° Medium Flood, 80° Flood (RGBW)
19° Narrow Spot, 25° Medium Spot, 30° Wide Spot (Gobo)
- Lens Options:** Horizontal Spread Lens, Vertical Spread Lens, Micro Honeycomb
Louver, Color Filter
- Options:** Dimming, Hi-Lo Switching, Dark Sky 0° Tilt
- Mounting:** Sistema, Single Wall, Double Wall

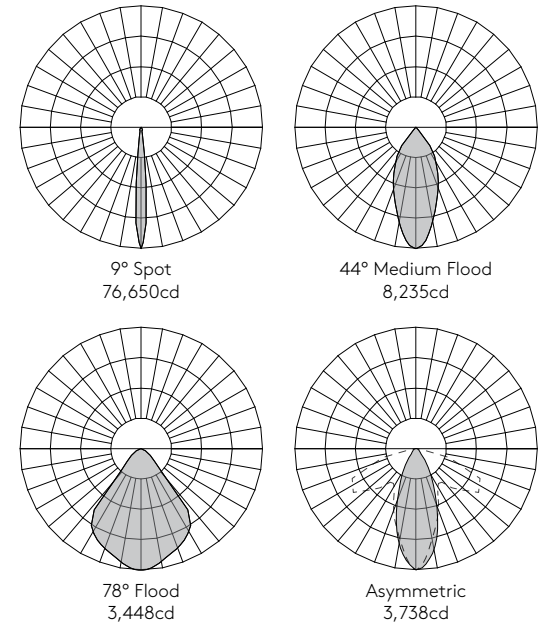

*Performances of Olivio Grande at 3000K

Grande

24-¹/₄"
(630mm)

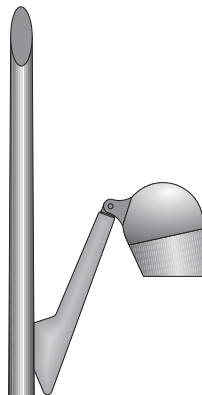

28-¹/₁₆"
(730mm)

Medio

24-¹/₄"
(616mm)

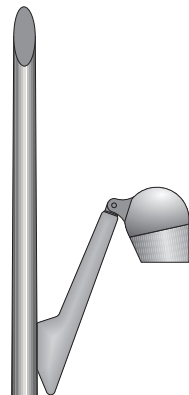

27-⁵/₁₆"
(710mm)

Refer to fixture specification sheet for detailed information on mounting configurations.

0° to 175° Tilt, 360° Rotation



River's Park Edge, Council Bluffs, Iowa
Photo courtesy of Tom Kessler Photography

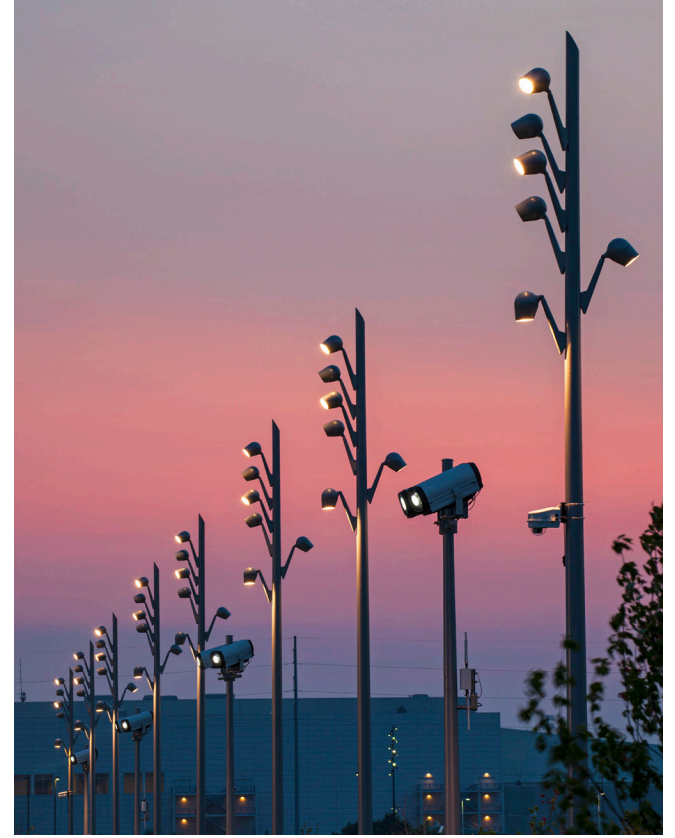

Starfield Hanam, Hanam, South Korea
Photo courtesy of Ahn Sohyun



Olivio LED Sistema 2



Product Specifications

- Series:** Piccolo, Medio, Grande
- Light Engine:** Recessed COB, RGBW (Grande only), Gobo Projector (Grande only)
- Output:** 600lm - 5,000lm nominal
- CCT:** 3000K, 4000K; 3 Step-Binning
- Distributions:** 9° Narrow Spot, 44° Medium Flood, 78° Flood, Asymmetric (White)
13° Narrow Spot, 50° Medium Flood, 80° Flood (RGBW)
19° Narrow Spot, 25° Medium Spot, 30° Wide Spot (Gobo)
- Lens Options:** Horizontal Spread Lens, Vertical Spread Lens, Micro Honeycomb
Louver, Color Filter
- Options:** Dimming, Hi-Lo Switching, Dark Sky 0° Tilt
- Mounting:** Sistema 2

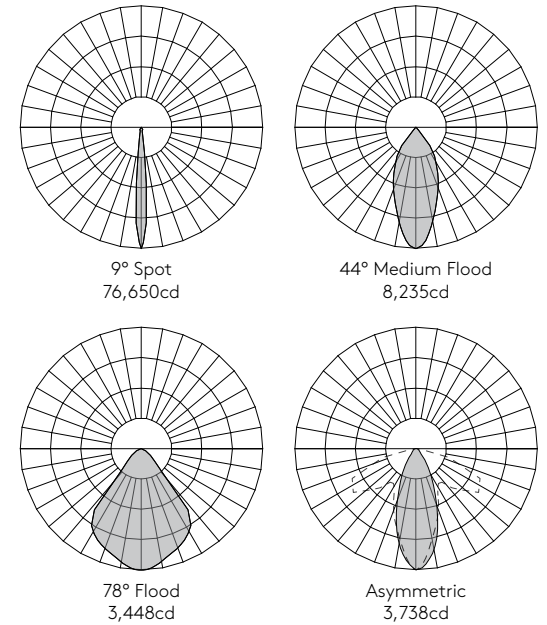

*Performances of Olivio Grande at 3000K

Grande

Medio

Piccolo

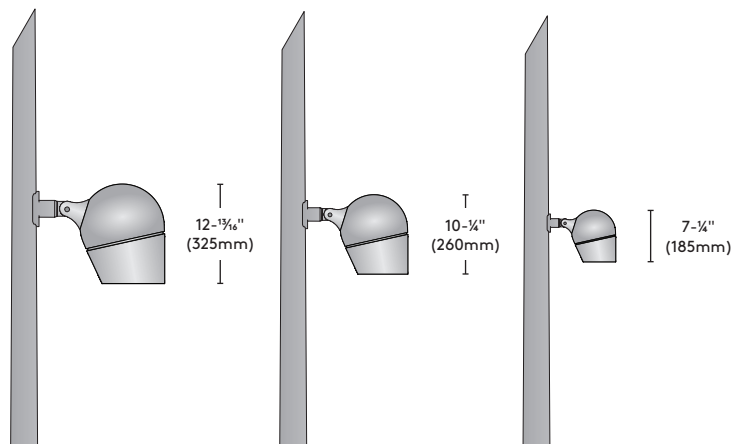

Refer to fixture specification sheet for detailed information on mounting configurations.

0° to 175° Tilt, 360° Rotation

Keiner Plaza, St. Louis, Missouri
Photo courtesy of Tom Paule



EXPO 2016 Antalya, Turkey
Photo courtesy of Emre Sahin

Olivio Medio LED Solar



Product Specifications

Series:	Medio
Light Engine:	Mid-power LEDs; 80+ CRI
Output:	1,400lm - 4,200lm nominal
CCT:	2700K, 3000K, 4000K; 3 Step-Binning
Distributions:	Diffuse Symmetric, Horizontal Spread, Vertical Spread
Batteries:	118 Ah, 146 Ah, 176 Ah (One or Two Batteries)
Panels:	110W or 160W (Single or Double Panels)
Options:	Various Dimming Profiles, Motion Sensor

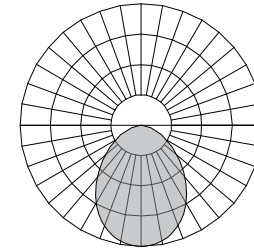

Diffuse Symmetric

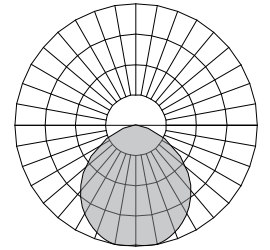

Horizontal Spread

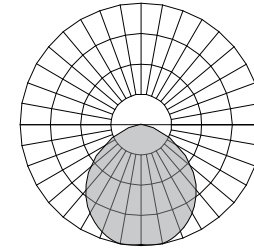

Vertical Spread

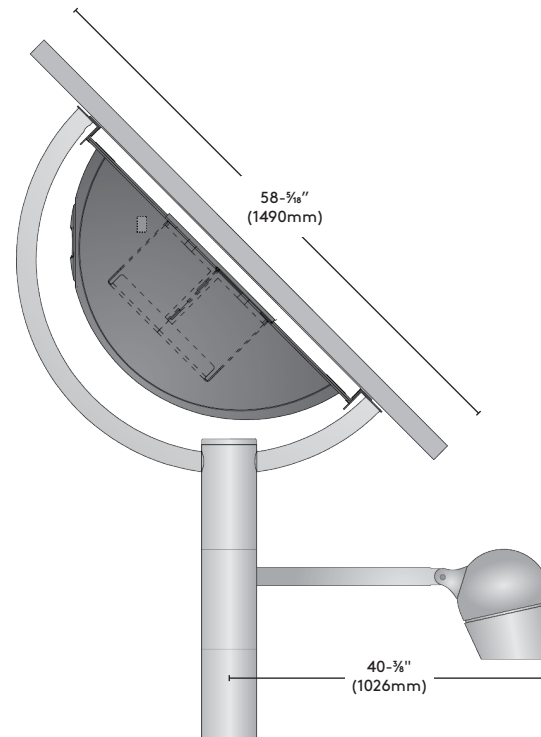

Medio

Refer to fixture specification sheet for detailed information on mounting configurations. Consult factory to determine battery, panel, panel mounting angle and operation profile.



Waterfront Lillsjöplan, Jönköping, Sweden
Photo courtesy of Per Johansson

Olivio Grande RGBW

Olivio Grande with RGBW enables unlimited color diversity. The special RGBW optic is based on a circular arrangement of colored and white LEDs inside a specialized reflector design for enhanced diffusion. Its geometry enables precision color mixing contained entirely within the optical unit.

Product Specifications

Series:	Grande
Light Engine:	RGBW
Output:	50W Max
CCT:	Red, Green, Blue, Static White (5734K)
Distributions:	13° Narrow Spot, 50° Medium Flood, 80° Flood

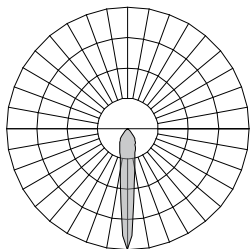

13° Narrow Spot
10,358cd

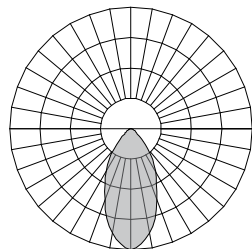

50° Medium Flood
3,227cd

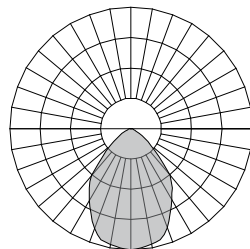

80° Flood
1,896cd



*In order to show LED arrangement, luminaire not shown with diffusing lens.

Olivio Grande GOBO Projector

Product Specifications

Series:	Grande
Light Engine:	Image Spot GOBO Projector
Output:	2,400 or 3,000lm nominal; 45W (ON/OFF - no dimming)
CCT:	3000K, 5500K
Distributions:	19° Narrow Spot, 25° Medium Spot, 30° Wide Spot
Options:	Hi-Temp DMX Projector good to 40°C (consult factory)

For projector Gobo options and accessories, consult factory.
Projector rated to IP65 standard for ingress protection.



Vattentorget, Vaxjo, Sweden
Photo courtesy of Werner Nystrand

Premium Quality Projection Technology for Graphic Light Scenes

Use the Olivio Grande GOBO projector to stimulate urban areas with projection effects like logos, graphics, text, photographs, etc.



Atmospheric Light in Hédas, Pau, France
Photo courtesy of Xavier Boymond



Vattentorget, Vaxjo, Sweden
Photo courtesy of Werner Nystrand

Publisher

Selux Corporation
5 Lumen Lane
Highland, NY 12528
www.selux.us

Edited by (responsible)

Selux Corporation

Concept and Design

Selux Corporation
www.selux.us

Print

Selux Corporation
5 Lumen Lane
Highland, NY 12528

Selux is a registered trademark of the Selux Corporation.
Errors accepted and subject to change due
to technical modifications. For conditions of sale
and delivery please refer to www.selux.us.

The use of the text and images, even in part, is
in breach of copyright without the consent of
the Selux Corporation and punishable. This also applies to
copies, translations, microfilming and processing
with electronic systems.

04/2023