

M 1 2 5

L E D

Application Guide

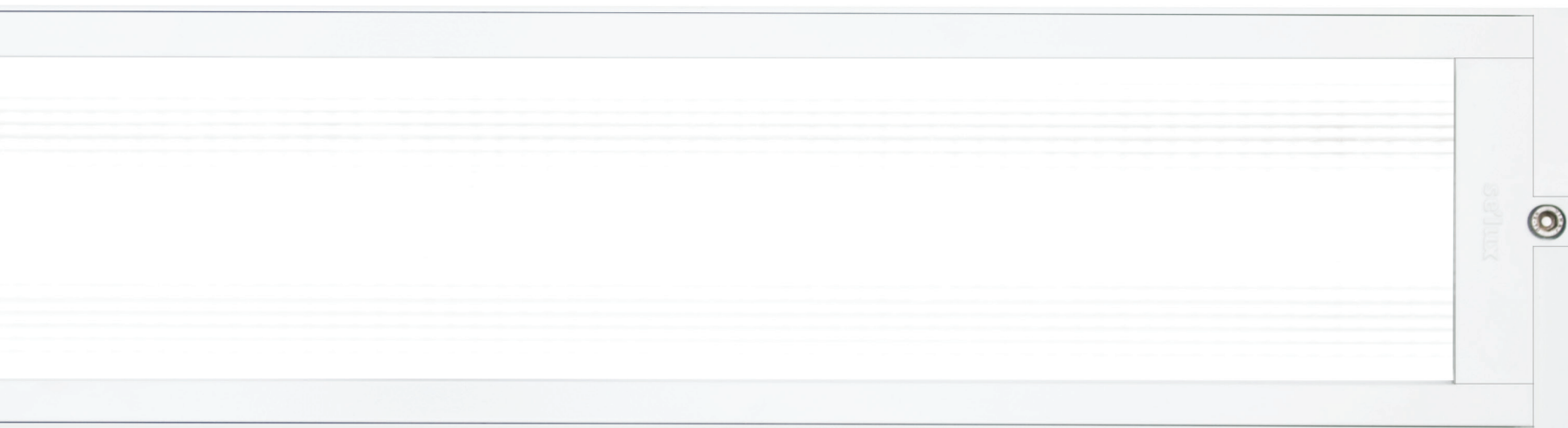

selux

M125 LED

Selux M125 is a luminaire essential for those needing light for safety - for interior or exterior applications. This luminaire has high-impact and access protection to IP65 and IK10 standards. Used individually or in runs for applications such as transportation stations, bus stops, parking garages, underpasses, and more, the M125 offers safe, efficient lighting, making it the perfect high protection luminaire for your next project.



Product Specifications

Light Engine:	Mid-power LEDs · 90+ CRI, 80+ CRI
Output:	Up to 2,025lm/ft · up to 101lm/W
CCT:	2700K · 3000K · 3500K · 4000K · 3-Step Binning
Shielding:	Tempered Clear Glass with LED Optimized Inlay or Microprismatic Inlay · Satine or Clear Polycarbonate Prismatic Lenses (IK10) · Clear or Diffuse Lens with: Symmetric · Asymmetric 20° Wall Washer · Asymmetric 5° Wall Grazer · Batwing
Options:	Single Fusing · Tamper Resistant · Separate Switching (consult factory) · Suitable for Natatorium Environment (consult factory) · End Feed Both Ends (for conduit daisy chain) · End Feed Left (for conduit) · End Feed Right (for conduit)
Emergency:	Emergency Circuit Wiring · Remote Micro Inverter (consult factory) · Cold-Weather Integral EM Battery Pack



When a light is needed for safety and protection against the elements

M125 is essential

The premium-quality materials of the M125 include extruded 6063-T6 aluminum, die cast aluminum end caps made from low copper aluminum, and marine-grade aluminum alloy.

The fully gasketed lens frame protects against moisture, dust, and insects, with an IP65 rating. It is perfect for harsh

environments because it was designed with vandal, tamper, and impact resistance.

This extremely robust family is available with various mounting options - pendant, wall mount, surface mount, or recessed.

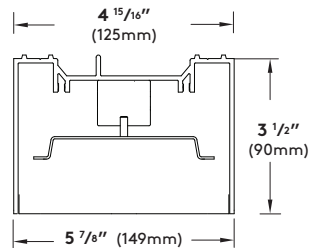

M125 Recessed

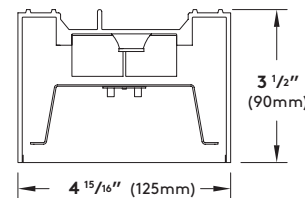

**M125
Surface / Pendant**

The New York State Office of Mental Health program certifies that Selux M125 can be used in locations where the mental health of patients may put them at risk, restricting areas for ligature and ensuring safety.





Variety of mounting options

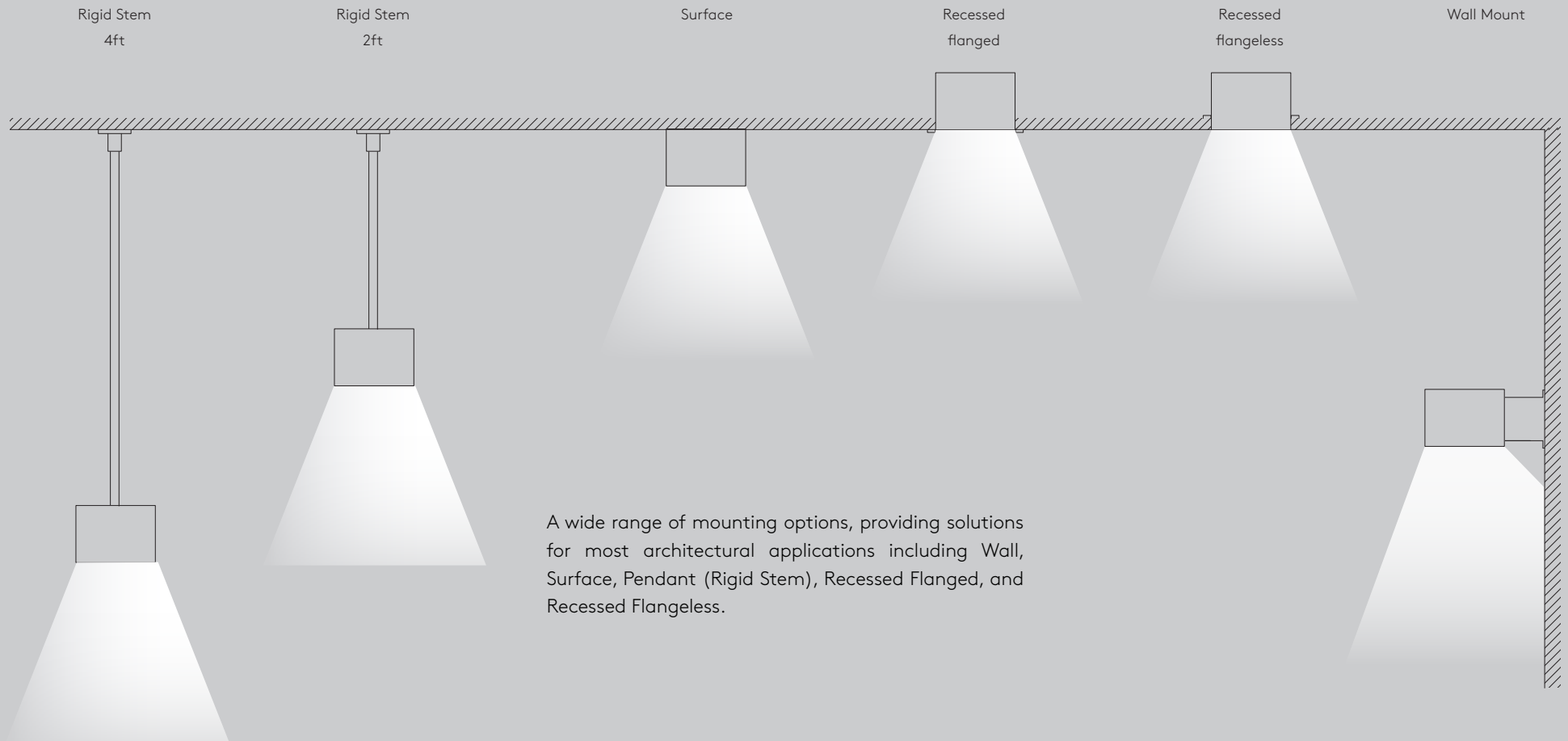

Optics and shielding

are the key to accomplishing optical control

In addition to being a rugged luminaire for both indoor and outdoor environments, M125 offers a wide range of LED optics and shielding options, creating a family of useful distributions.

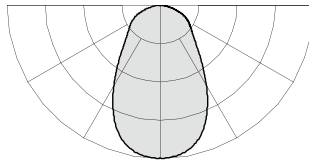

(LI) - Clear Glass with
LED Optimized Inlay

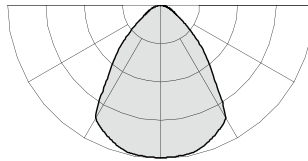

(MI) - Clear Lens with
Microprismatic Inlay

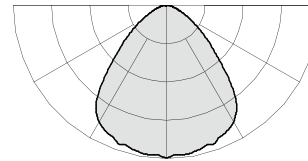

(PC) - Prismatic Lens
(IK10 Rated)

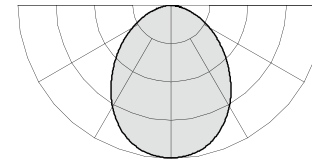

(SD) - Satine Lens
(IK10 Rated)

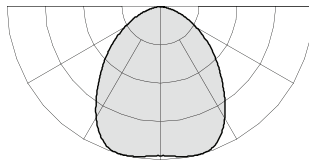

(CNB) - Clear Lens
LMO Symmetric

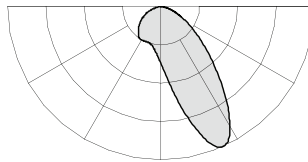

(CA2) - Clear Lens LMO
Asymmetric 20° Wall Washer

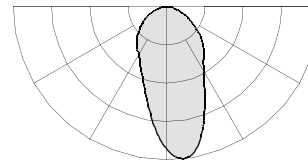

(CA5) - Clear Lens LMO
Asymmetric 5° Wall Grazer

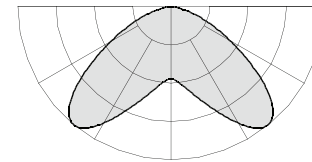

(CBW) - Clear Lens
LMO Batwing

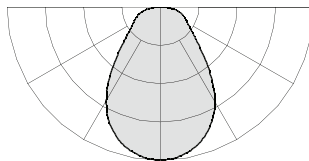

(DNB) - Diffuse Lens
LMO Batwing
(IK10 Rated)

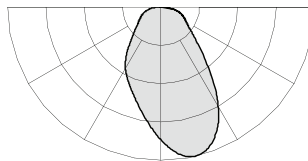

(DA2) - Diffuse Lens LMO
Asymmetric 20° Wall Washer
(IK10 Rated)

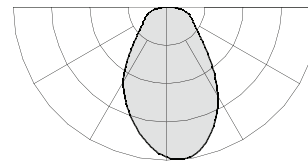

(DA5) - Diffuse Lens LMO
Asymmetric 5° Wall Grazer
(IK10 Rated)

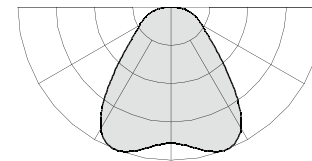

(DBW) - Diffuse Lens
LMO Batwing
(IK10 Rated)

M125 application



Single or double row LED boards

depending on your illumination necessity

M125 has brand-name mid-power LEDs that create a high efficiency LED light engine. It is able to provide a lumen maintenance of 96% at 25,000 hours and 93% at 60,000 hours. M125 gives you the choice to have one light engine or two - depending on your project needs. Both light engines are at 25°C per TM-21 reports. Reported L70 greater than 60,000 hours.

The M125 is available with single row or double row LED board. Both provide one similar thing - illumination. The choice is yours on how much illumination intensity you

need for your project. The double row LED boards are made of two horizontal rows of LEDs and are placed side-by-side. Double row LED lights are the preferred choice if you want to illuminate huge spaces such as offices, warehouses, or large parking garages.



Porsche Centre Oakville, Ontario, Canada - Photographer: ScarFone Photography



Water tight for run lengths

M125 is available in 2ft, 3ft, or 4ft standard lengths, but to maximize its use, it is also available in run lengths. The runs are available in the standard length increments and are ideal for illuminating a large extended area or for highlighting a long element.

The water-tight nipple connections are supplied with all runs for easy connection, and to keep you feeling assured that the wires and cables are free of liquid and moisture.

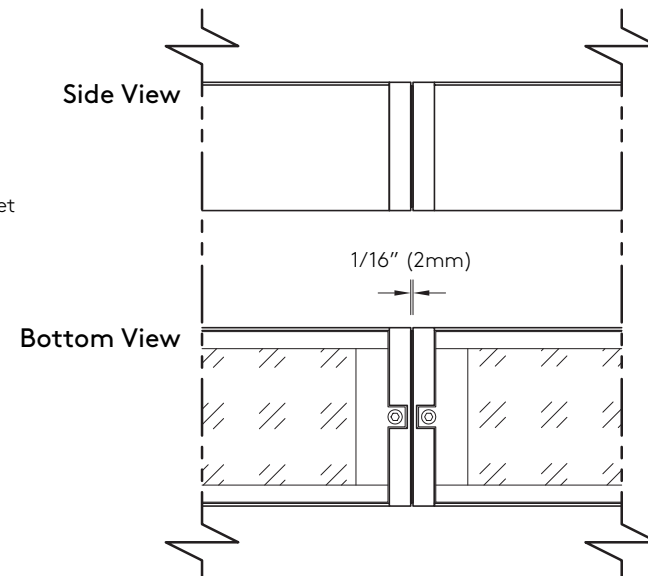
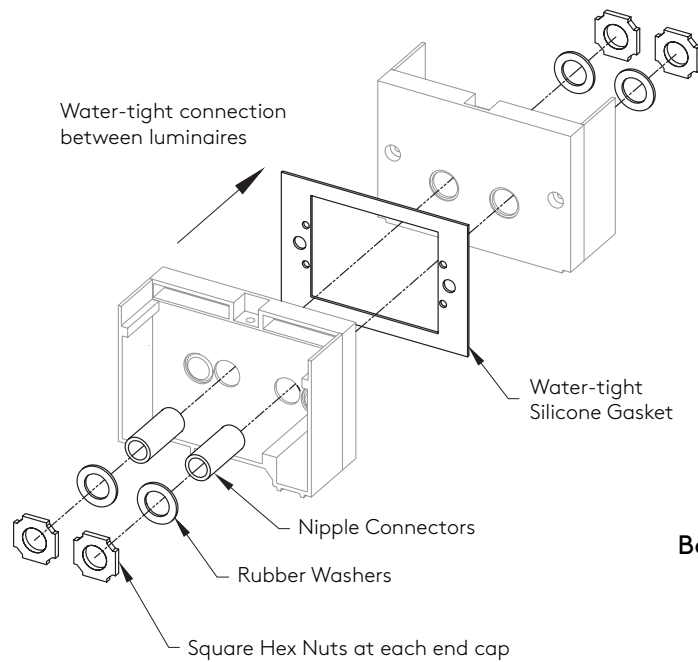



Joe Murray Rivers, Jr. Intermodal Transit Center, Savannah, Georgia - Photographer: Atlantic Archives, Inc.



Terminal 2, Heathrow Airport, UK - Photo courtesy of: James Newton



Cold-Weather Integral Battery

As temperatures continue to get colder in some areas, help protect your M125 with the Cold-Weather Integral Battery Pack option. With this, it can withstand the harshest and coldest weather conditions unlike others which can become weaker in extreme cold temperatures, ensuring proper emergency lighting even in these extreme temperatures.



Separate Switching

Luminaires available with separately switched (nominal) sections starting at 7' and up. Luminaire is intended to be wired to the same panel/breaker (not intended for emergency use).

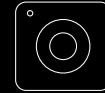

Visual/Audio Integration

Need to add additional security measures or audio function to create a memorable experience or provide informative voice commands? On a project-specific basis, Selux can integrate cameras, speakers, or other accessories (all by others) into the M125 LED. Consult factory for details.

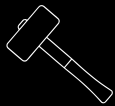

Tamper Resistant

This vandal-resistant fixture is designed and manufactured for scenarios where the luminaire needs to withstand impact, tampering, prying, or severe weather. Tamper proof, the M125 can be utilized in behavioral health centers, correctional institutions, schools, hospitals, shopping centers, or any high occupancy locations.



Suitable for Natatorium Environment

Natatorium environments create extremes in temperature, humidity, evaporation, vapor pressure, and multitude of other factors. M125 can withstand harsh vapors and humidity while maintaining its original corrosion-free form. Consult factory for details.



Selux Housing Finishes



white

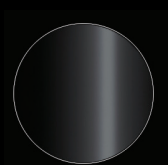
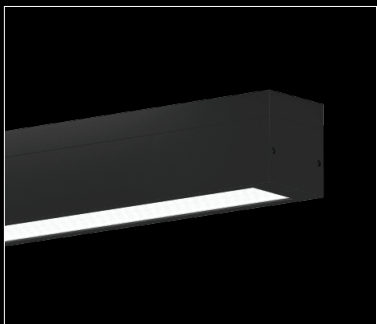

semi-matte
black

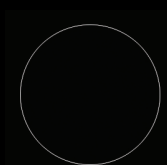

semi-matte
black



silver



custom RAL
finish

M125 application





Publisher

Selux Corporation
5 Lumen Lane
Highland, NY 12528
www.selux.us

Edited by (responsible)

Selux Corporation

Concept and Design

Selux Corporation
www.selux.us

Print

Selux Corporation
5 Lumen Lane
Highland, NY 12528

Selux is a registered trademark of the Selux Corporation.
Errors accepted and subject to change due
to technical modifications. For conditions of sale
and delivery please refer to www.selux.us.

The use of the text and images, even in part, is
in breach of copyright without the consent of
the Selux Corporation and punishable. This also applies to
copies, translations, microfilming and processing
with electronic systems.

12/2025

